



allPIXA *evo*

HIGH PERFORMANCE LINE SCAN CAMERA SERIES

16k MONO RGB

HIGH RESOLUTION
FAST INTERFACES
LOW NOISE

CoaXPress®

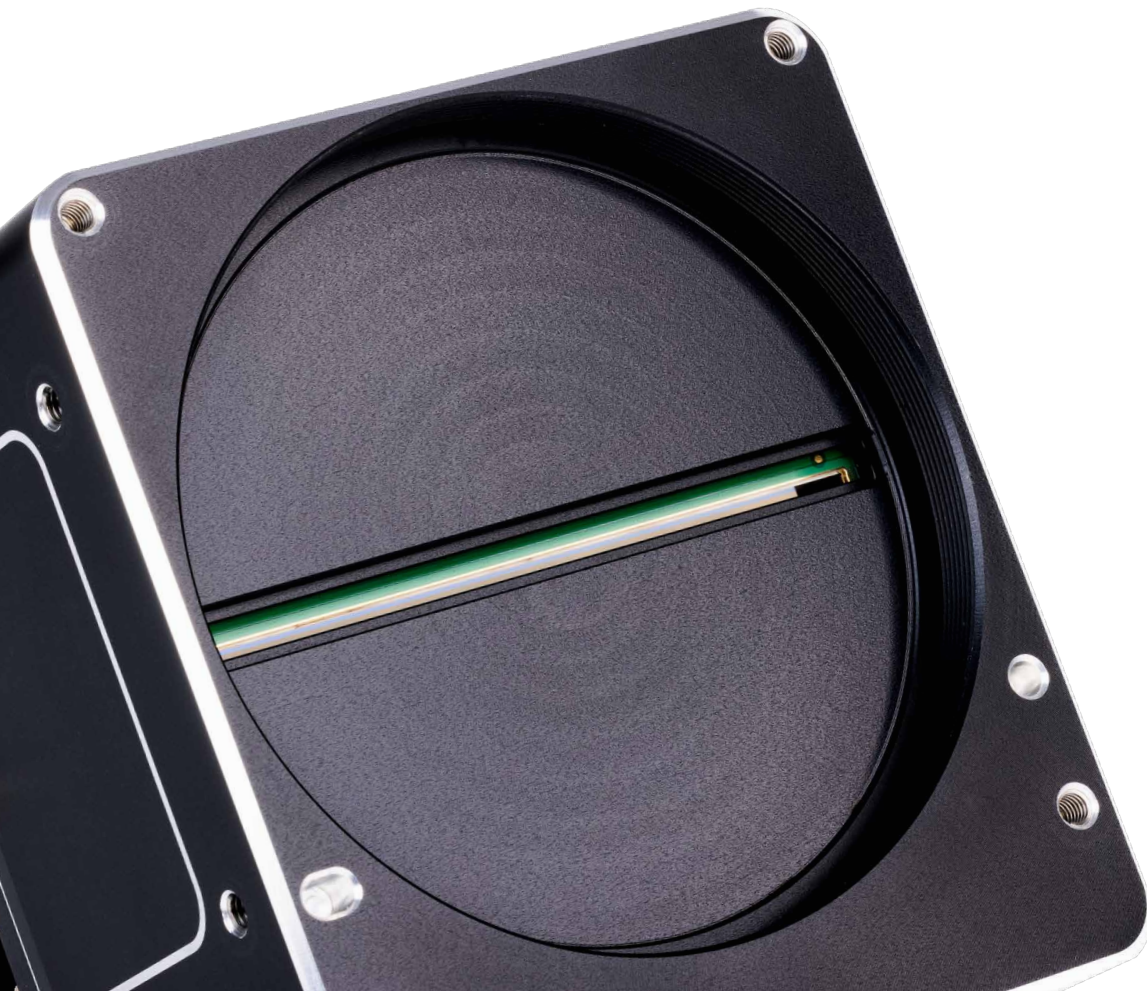

16k



allPIXA evo 16k

Line Scan Camera with 4x CoaXPress



CoaXPress® CXP-12 GEN*i*CAM

The powerful allPIXA evo 16k line scan camera delivers exceptional performance with quadlinear CMOS sensors in CCD image quality in Mono & RGB. It can reach line rates up to 200 kHz (Mono). The 4x CoaXPress version offers extremely high data bandwidth for challenging industrial applications.

The multi-field feature provides up to four images (e.g. bright and darkfield) in a single pass. The GCT (GenICam Control Tool) software tool enables easy set-up through graphical supported configuration. The SDK helps for quick integration into any industrial environment, whereas the camera can be integrated with any GenICam compliant development kit. This enables rapid implementation of camera control and high-speed image acquisition under Windows or Linux.

CAMERA OVERVIEW:

- ▶ CMOS multi-line sensor with 16,384 pixels
- ▶ Pixel size: 5 µm
- ▶ Interfaces: 4x CoaXPress CXP-12 (HD-BNC)
- ▶ Supports PoCXP (Power over CoaXPress)
- ▶ High speed: up to 73 kHz in Color
up to 200 kHz in Mono
- ▶ Output of Mono, RGB, RGB+Mono
- ▶ Optical mount: M95

FEATURES:

- ▶ Frame and line trigger options including variable encoder input
- ▶ DSNU and PRNU correction
- ▶ Continuous and automatic white balancing
- ▶ Precise multi-camera synchronization
- ▶ Multi-field imaging features for multiple image acquisition in one pass via line synchronized LED strobe control
- ▶ Color correction matrix for optimized color image representation
- ▶ SDK and graphical tool for Windows and Linux
- ▶ Fully GenICam and GigE Vision compliant

TYPICAL APPLICATIONS:

- AOI / PCB Inspection
- Wafer inspection
- Inkjet print inspection
- Print & color inspection
- high speed web & foil inspection
- Battery electrode foil inspection
- Flat panel inspection

SPECIFICATIONS

allPIXA evo 16k	
Interface	CoaXPress [®]
Sensor	CMOS
Number of pixels	16,384
Active pixel size	5 μm x 5 μm
Interface connector	4x CXP-12
Max. line rate Mono: 16,384 x 1 (8 Bit)	200 kHz
Max. line rate Color: 16,384 x 3 (8 Bit)	73 kHz
Power over CXP	PoCXP
Power supply	12-24V DC \pm 10% Hirose
Trigger mode	Free run / Line trigger / Frame trigger
Operating temperature	0° to 60° housing temperature
Dimensions	102 x 113 x 100 mm
Lens mount	M95 x 1
Weight	1.100 g
Certifications	CE; RoHS; REACH

SPECTRAL SENSITIVITY (MONO AND COLOR)

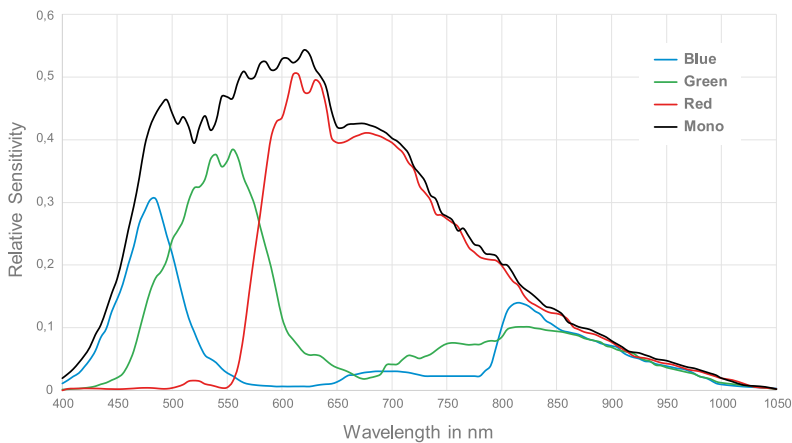

SENSOR LINES

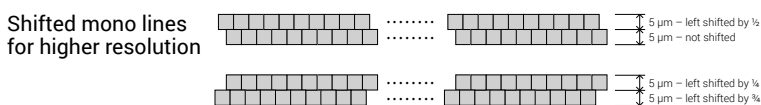
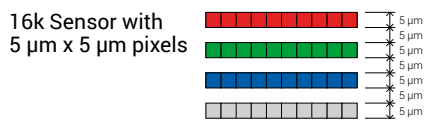

DRAWINGS

allPIXA evo 16k Z
CoaXPress

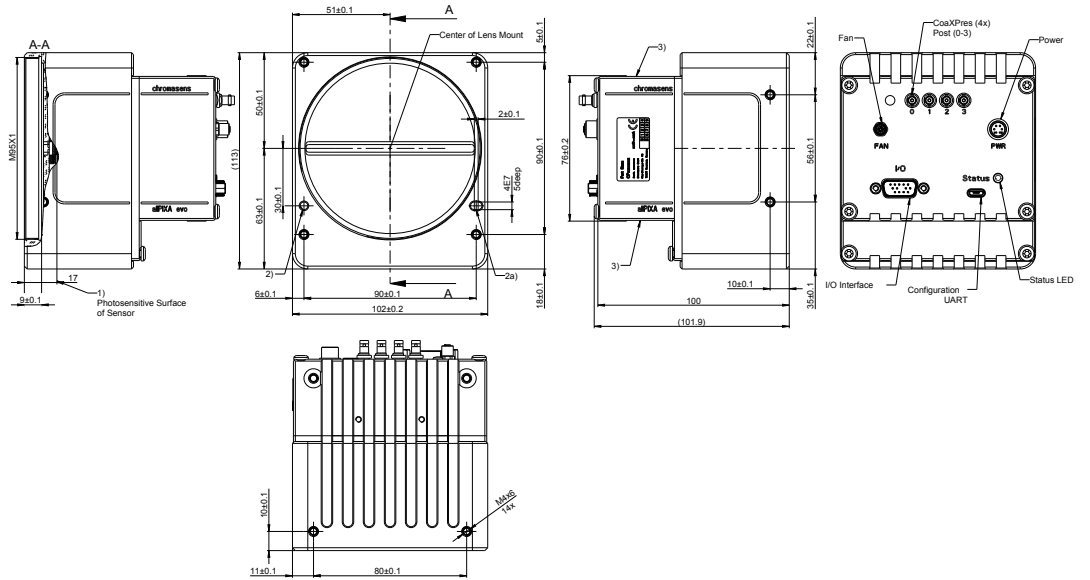

allPIXA evo 16k Y
CoaXPress

