

9±0.1

17

M72x0.75

1) Photosensitive Surface of CMOS-Sensor

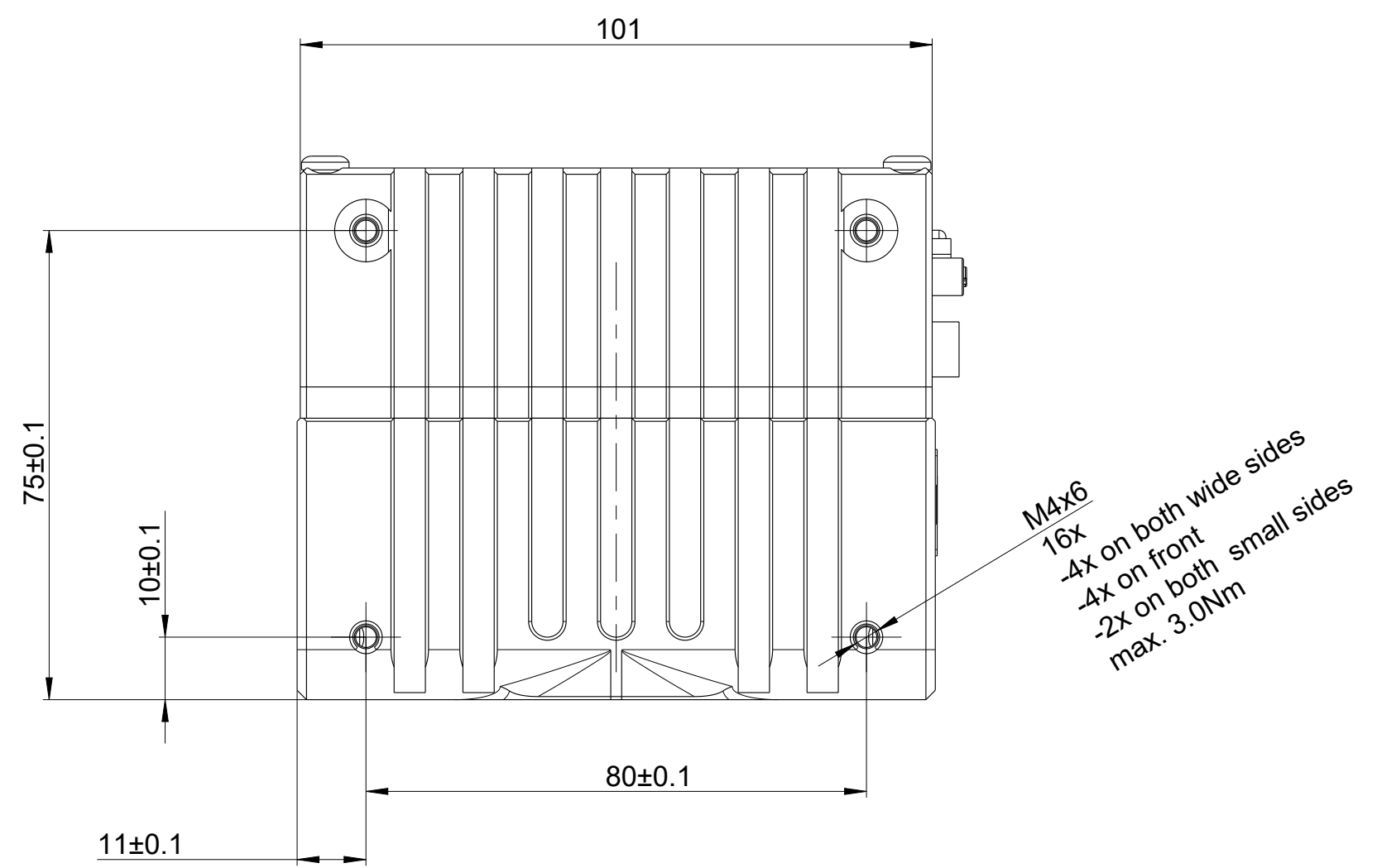
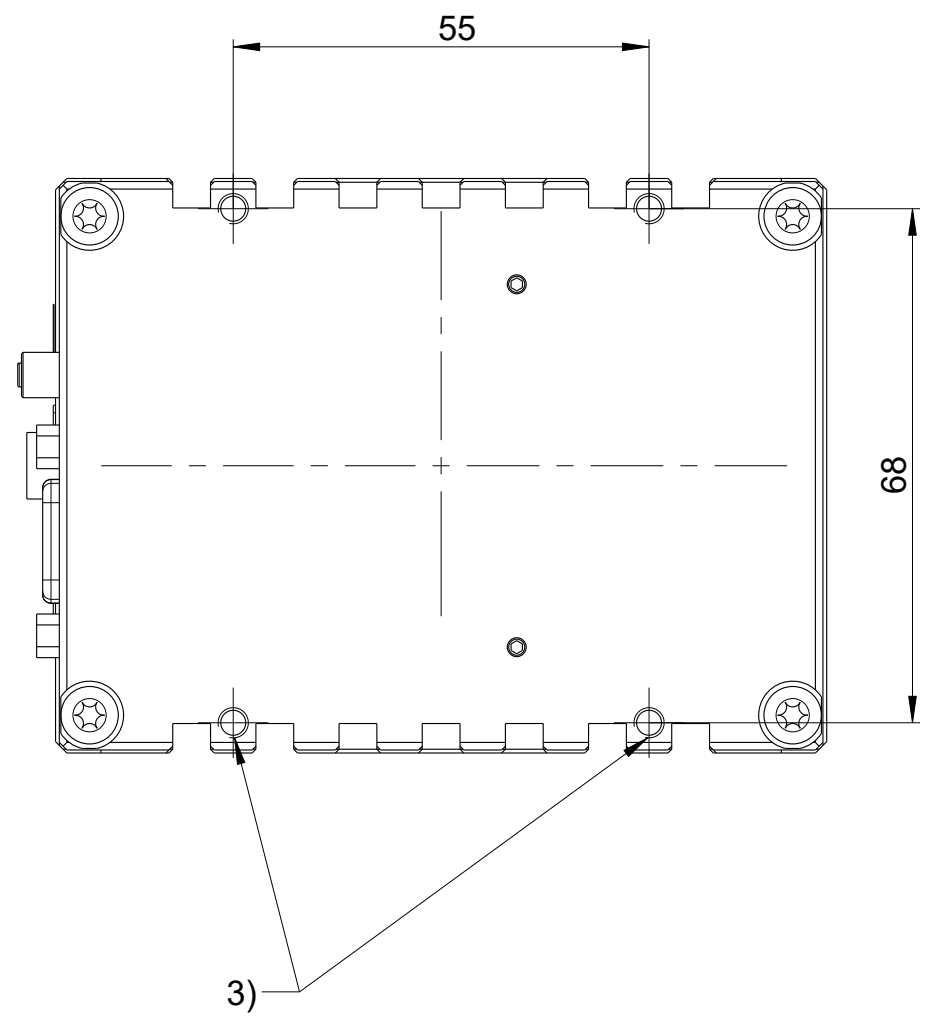
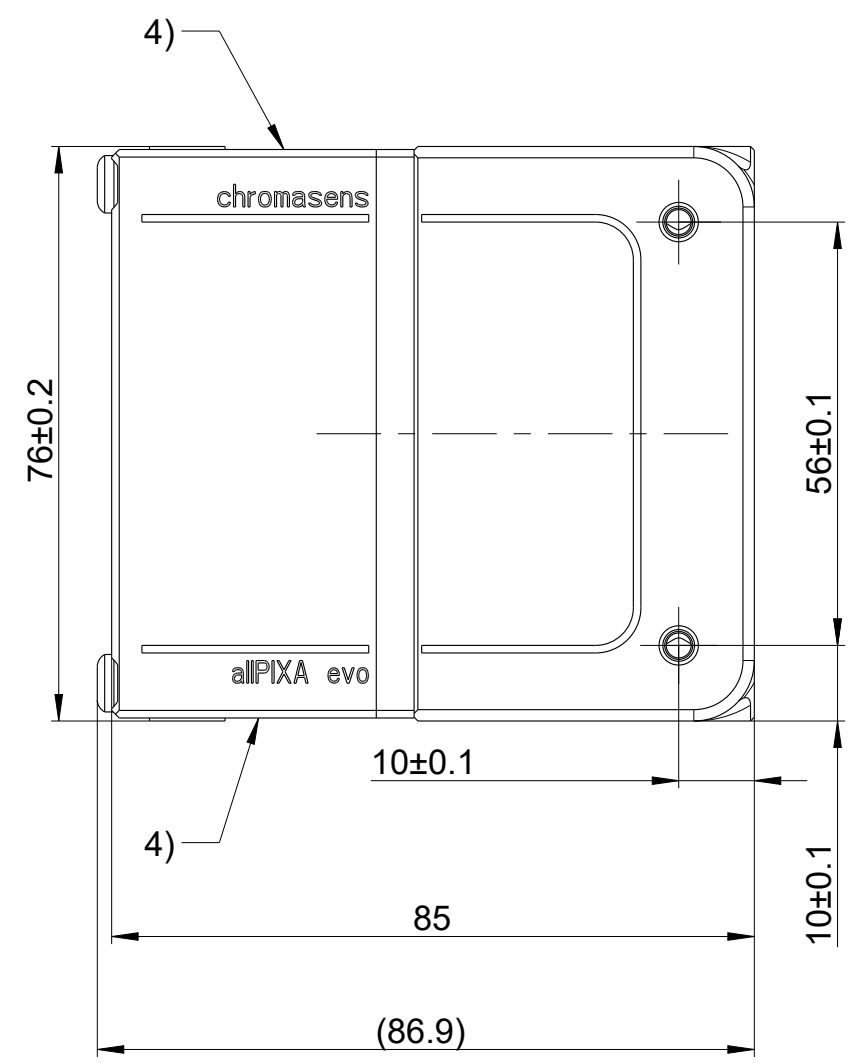
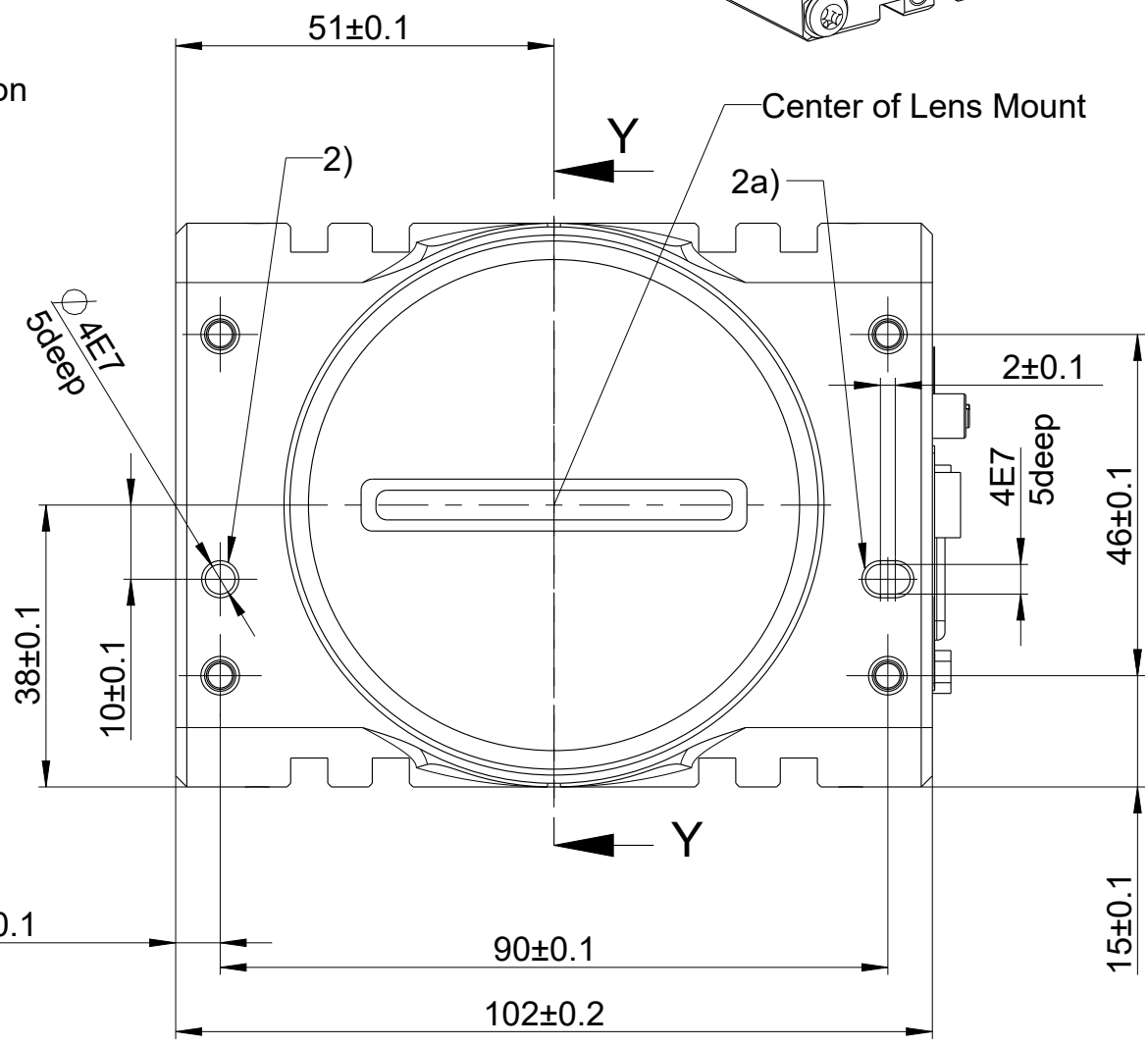
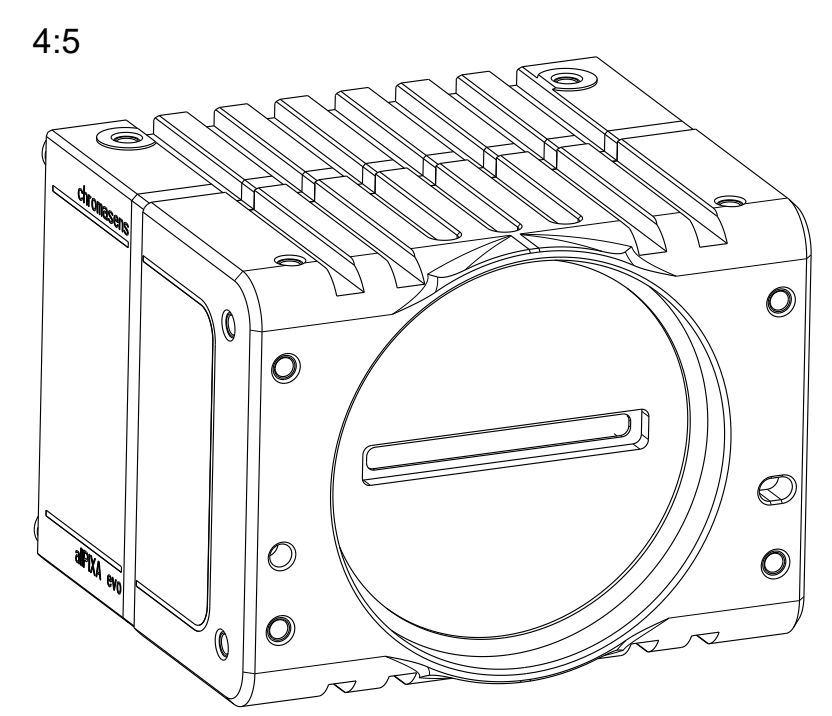
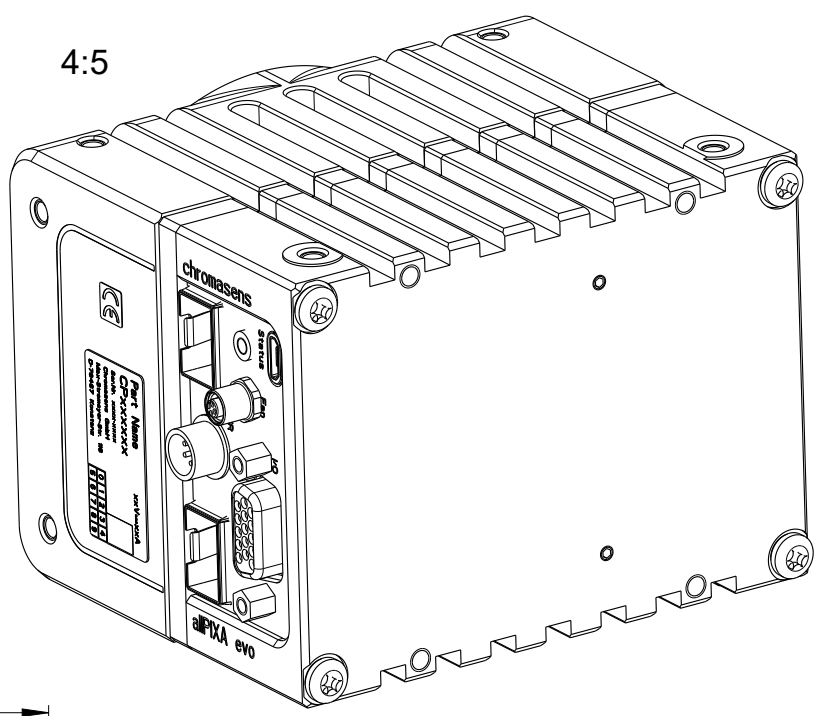

1) Photosensitive Surface of Sensor:
 17,0mm (optical, with sensor glas elongation)
 16,76mm (mechanical),
 -> 3D-Model geometry is in consideration of the optical path.
 -> sensor tolerances according user manual

2) Positioning Hole \varnothing 4E7 for Pin \varnothing 4mm (Tolerance m6) and floating side 2a) (4E7x3mm).

3) threads for cooling options M4x8 max. 1.0Nm (ask for Accessoires)

4) Thermal pad for Cooling options (see accessoires)

Positioning and Tolerances according to User Manual

CONFIADO COMO SECRETO INDUSTRIAL . NOS RESERVAMOS TODOS LOS DERECHOS
 PROPRIETARY DATA , COMPANY CONFIDENTIAL . ALL RIGHTS RESERVED
 Weitergabe sowie Vervielfaeltigung dieser Unterlage . Verwertung und Mitteilung ihres Inhalts nicht gestattet , soweit nicht ausdrecklich zugestanden . Zuwiderhandlungen verpflichten zu Schadensersatz . Alle Rechte vorbehalten , insbesondere fuer den Fall der Patenterteilung oder GM-Eintragung .

ISO 128		Tol ISO 8015 DIN 2768 - mH		ISO 1302		Massstab 1:1		Creo4.0	
ISO 128		Tol ISO 8015 DIN 2768 - mH		ISO 1302		CP000620-S-08K-11-X			
				Datum: 12.11.2020		allPIXA evo2 8K DxGE-X		Blatt	
				Name: Joggerst					
				Gepr.:					
02				-		Chromasens GmbH			
Zust		Mitteilung		Datum		Name		Max. Steuertemperatur 118 GER 13047 Konstante	
						CM060-B650-V1000-C		1 / 1	